



# EF Series

## Installation Guide

(Please read the following steps to assemble)

Please note that the pictures in this installation guide are for reference only, and may vary from the actual product.



### 【Opening the Chassis】

1. Removing the Side Panels  
Unlock the clips then remove both side panels. [1](#) [2](#) [3](#)
2. Removing the Front Panel  
Unlock the locking tabs and remove the front panel. [4](#)

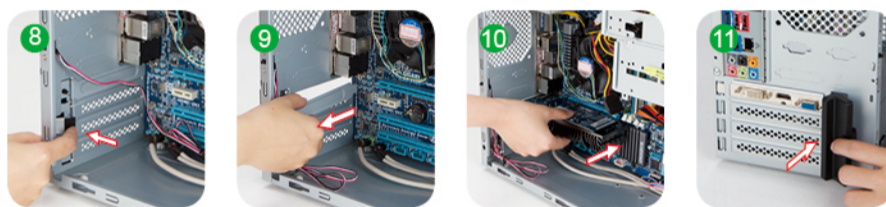

### 【Power Supply Installation】

3. With its fan facing down, insert the power supply into the chassis and secure it with the screws. [5](#) [6](#)

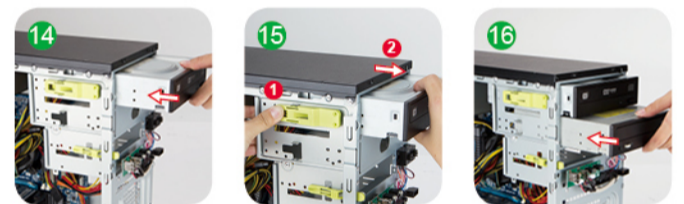
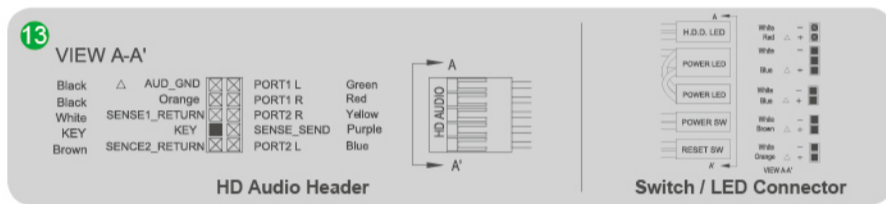
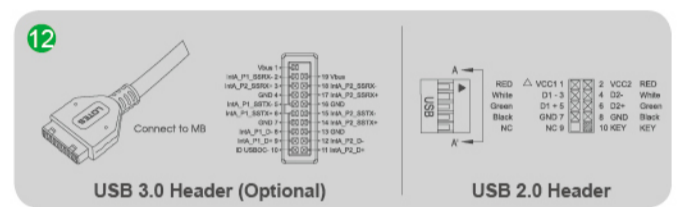

### 【Motherboard Installation】

4. Follow the MB Installation Guide to install and connect the power cables to the MB. [7](#)
5. Equip I/O-shield, Motherboard, CPU, Memory and heat sink.

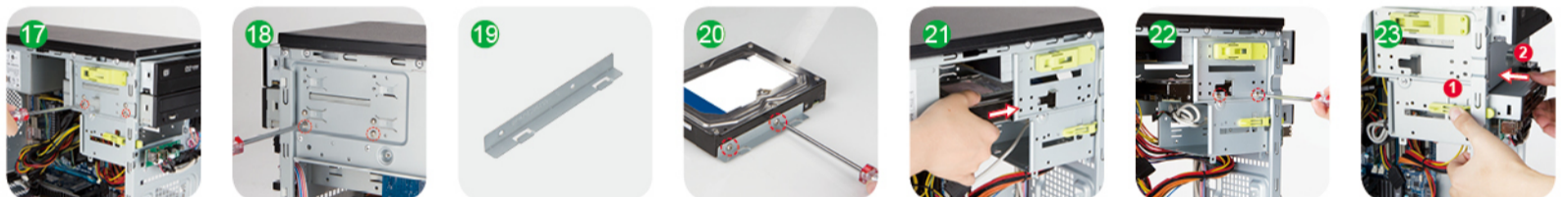

### 【Add-on Card (PCI-E) Installation】

6. Press the locking clip and remove the I/O slot cover. [8](#) [9](#)
7. Equip Add-on cards. [10](#)
8. Lock the locking clip. [11](#)



### 【Front I/O Wires Installation】

9. Connect cables to the MB. [12](#) [13](#)



### 【5.25" Drive Bay Installation】

10. Tool-Free 5.25" Drive Bay  
Slide the ODD into the top 5.25" drive bay, and push the ODD until it hitches into place. [14](#)  
Connect the data and power cables to the ODD.
- \* Note: To remove the ODD, please press the retaining clip, then pull the ODD forward. [15](#)
11. 5.25" Drive Bay  
Slide the ODD into the bottom 5.25" drive bay, and secure it with screws. [16](#) [17](#) [18](#)  
Connect the data and power cables to the ODD.
12. 5.25" to 3.5" Drive Bay Installation (Optional)  
Secure the 3.5" HDD and bracket with screws. [19](#) [20](#)  
Slide the 3.5" HDD into the cage and secure it with screws. [21](#) [22](#)



### 【External 3.5" Drive Bay Installation】

13. Press the clip and slide the 3.5" device into the FDD bay. Align the screw holes and secure it by the clip. [23](#)  
Connect the data and power cables to the 3.5" device.
- \* Note: To remove 3.5" device, please press the FDD retaining clip, then push the 3.5" device forward.

### 【Internal 2.5" HDD Installation】

15. Place the 2.5" HDD in the 2.5" HDD mounting area, and secure it with screws. [31](#) [32](#) | [33](#) [34](#)  
Connect the data and power cables.

### 【Installation Complete】

18. Remove the 5.25" or 3.5" cover if necessary. [39](#) [40](#)
19. Lock the front panel and side panels clips to close chassis. [41](#) [42](#) [43](#)

\* The actual product is subject to change without prior notice. In Win Development Inc. reserves the right to make final modifications.

### 【Internal 3.5" Drive Bay Installation】

14. Equip 3.5" HDD into the HDD cage (or 3.5" HDD mounting area), secure it with screws and connect the data and power cables. [24](#) [25](#) [26](#) | [27](#) [28](#) | [29](#) [30](#)
- \* Note: If the 3.5" HDD is equipped at front panel, the front fan cannot be installed. [27](#) [35](#)

### 【Cooling Fan Installation】 (Optional)

16. Front Fan Installation :  
Equip the 90mm fan and fan holder to the front panel. Connect cables to the PSU or MB. [35](#) [36](#)
17. Rear Fan Installation  
Place the 90mm fan at the rear panel and secure it with screws. Connect cables to the PSU or MB. [37](#) [38](#)